



Philips Consumer Lifestyle

Service Manual

PRODUCT INFORMATION

Safety info

- This product meets the requirements regarding interference suppression on radio and TV.
- After the product has been repaired, it should function properly and has to meet the safety requirements as officially laid down at this moment.

TECHNICAL INFORMATION

- Voltage : 220 - 240 V
- Frequency : 50 - 60 Hz
- Power consumption : 1425 W
- Product dimensions (W x H x D) : 287 x 315 x 384 mm
- Cord length : 1 meter
- Materials : Outer skin : Plastic (PP)
 - : Pan : Aluminized steel
 - : Basket : Aluminized steel
 - : Basket mesh : Stainless steel
 - : Coating : PTFE coating
- Capacity : 2.2 liter (till max indicator)
- Weight : 7.0 kg
- Coloursetting : Black
- Temperature : 80 till 200 °C
- Fuse cut-off temp. Motor : 145 °C
TCO : 190 °C
- SAP coding : HD9220/20

OPTIONAL (accessories)

- No specific issues

Part/System	Test	Possible deviation	Analyses	Replace (depending of the analyses outcome)
Timer	Check if the green light is lit, and if you can hear the timer ticking	The green light is not lit but the timer is ticking	Check the timer-switch and the fuse with a multimeter	Timer/Fuse
		The green light is lit but the timer is not ticking	Timer is defective	Timer
Thermostat	Set the temperature at 80 °C and check if the heating element is getting warm (Check input power approx. 1425 W) The green light should be lit and the orange light should switch off after it reaches 80 °C	Both green and orange light are lit but there is no heating	Check the heating element with a multimeter	Heating element
		If the green light is lit and the orange light is off	Check the thermostat with a multimeter	Thermostat
		If both the green and orange light are off	Check the timer and fuse with a multimeter	Timer/Fuse
		The orange light does not switch off after reaching approx. 80 °C	Thermostat is defective	Thermostat
Motor fan assy	Set the timer and listen if the motor is running	Motor is not running	The fan is scraping the housing turning it by hand (Switch off the power when you do this test!)	Motor fan assy
			The fan is not scraping the housing turning it by hand (Switch off the power when you do this test!): Check the motor fan assy, timer and fuse with a multi meter	Motor fan assy / Timer/Fuse
Heating element	Check if the heating element is getting warm (Check input power approx. 1425 W)	If the Orange light is on and the heating element does not heat	Check the heating element with a multimeter	Heating element
		If the heating element does not heat and the orange light is off	Check the timer, fuse and thermostat with a multimeter	Timer/Fuse/ Thermostat
Thermal fuse	Set the timer and check if the green light is lit	Green light is not lit	Check the timer and fuse with a multimeter	Timer/Fuse

General remark;

When you need to disconnect a wire from the crimp housing, please cut the wire half way (See ✂ in the picture below) and always connect the wires with a new 2 wire crimp housing 4222 459 51851. To crimp the housing use the Lobster AK25 No2 or Muromoto Tekko MR30A Nr 2 with Air pressure = 6 kg/cm².

Crimp instruction CE2

- 1) Strip wires: 16mm (0.63 in) Max. 13mm (0.51) Min.
- 2) Twist the wires together along the entire length of the strip and insert them into crimp housing .
- 3) Center the crimp tool on the sleeve.
- 4) Crimp the housing with 6 kg/cm².

Route the wire route, using 5 tie-wraps according the picture below;

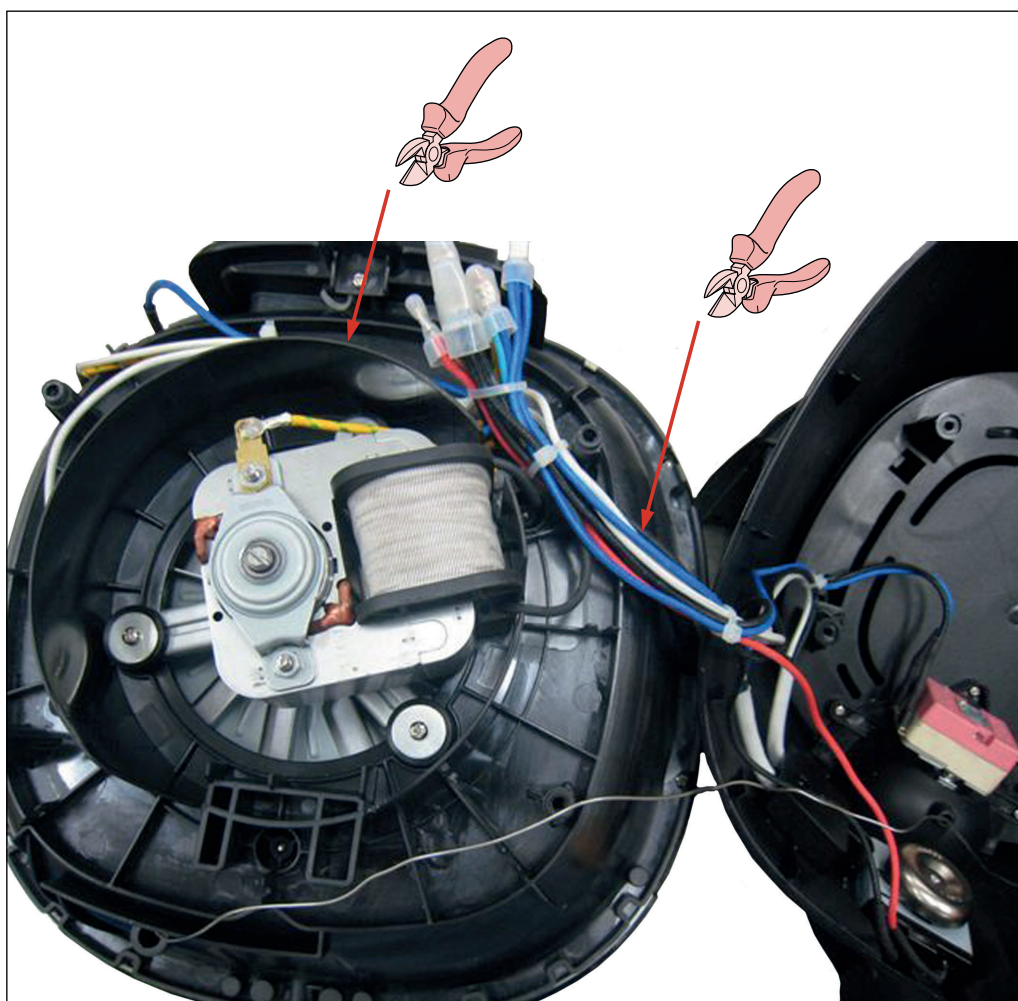

A. Top cover removal

1. Open the cover from the top cover by using a flathead screw driver to open the 6 click connections.

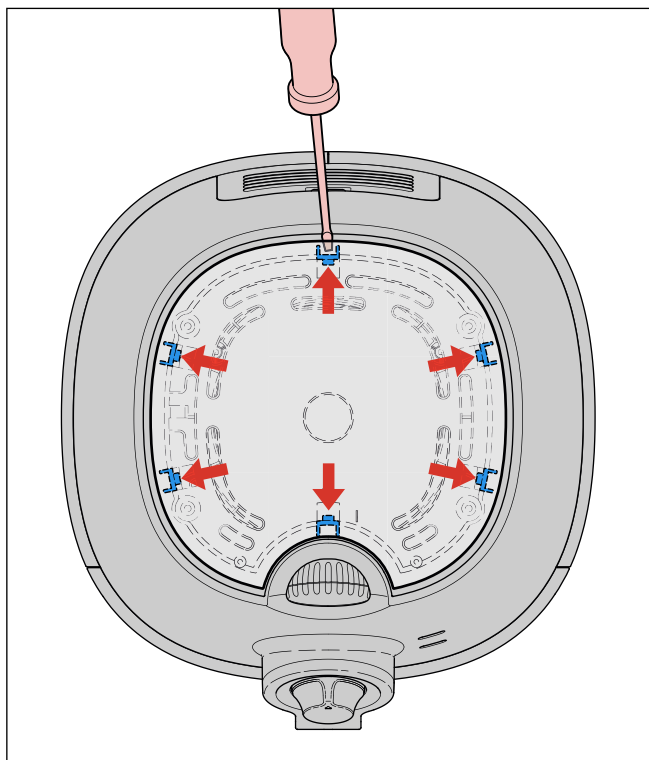

2. Use a crosshead screw driver to unscrew the 4 screws **A**.

Note: When you close the top cover, use a screw torque off 50 till 80 Nm (5 to 8 kgf.cm)

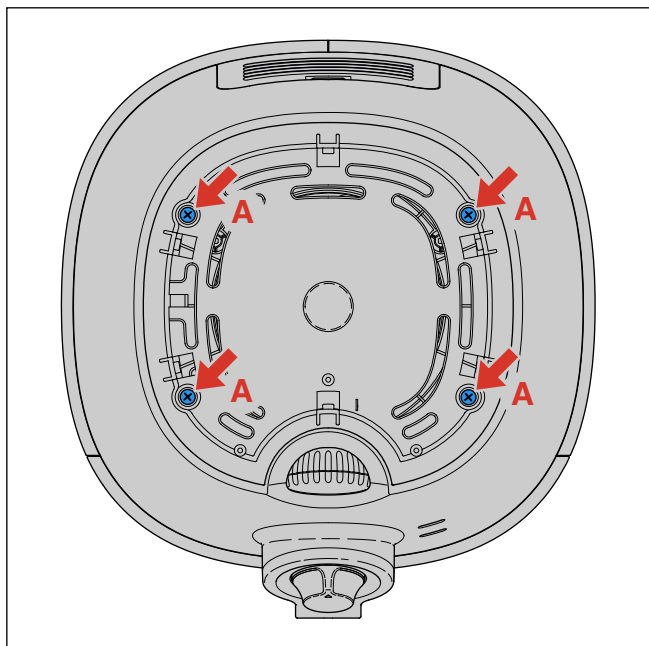

3. Use a flathead screw driver to open the "timer top cover" and pull the knob from the appliance.

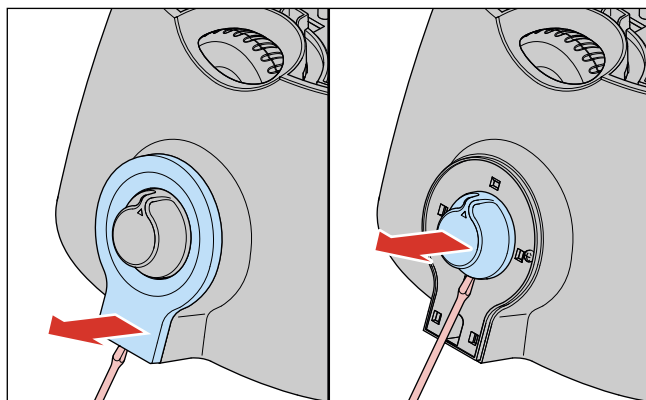

4. Unscrew the screw **B** under the timer top cover.

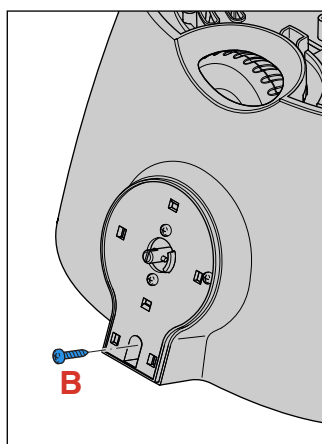

Note: Replace the timer cover and / or the cover in case of damage and / or scratches.

Tip: Open the "timer cover" from the bottom side, to avoid scratches on visible places.

B. Cover housing removal

1. Follow previous step A
2. Open the motor fan assy from the base by unscrewing the 6 screws **C**. Be aware of the 2 screws under the filter.

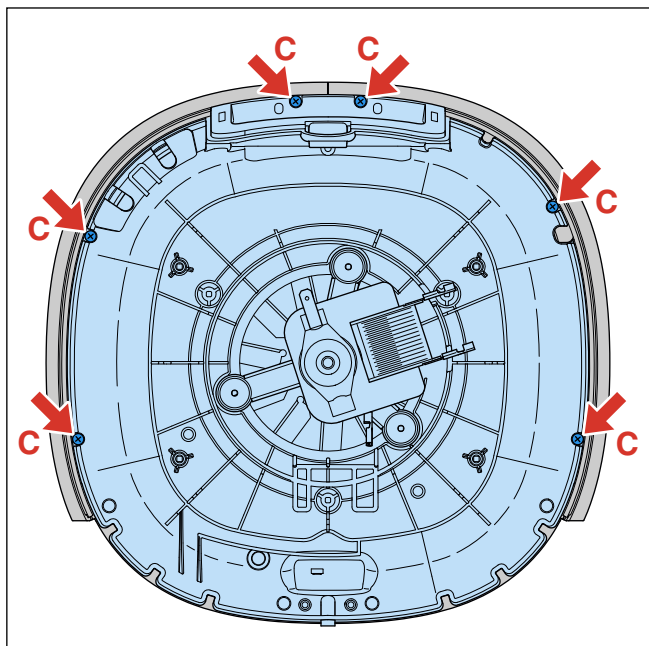
**D. Double heat shield removal**

1. Follow previous step A, B and C
2. Remove the double heat shield out of the motor fan assy by unscrewing the 3 screws **E**.

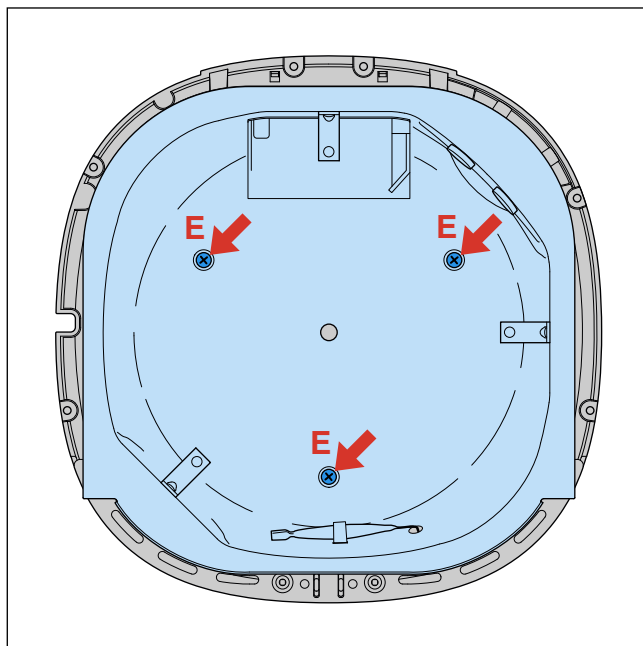
**C. Heating element + Fan Removeal**

1. Follow previous step A and B
2. Undo the heating element from the double heat shield by unscrewing the 3 screws **D**.

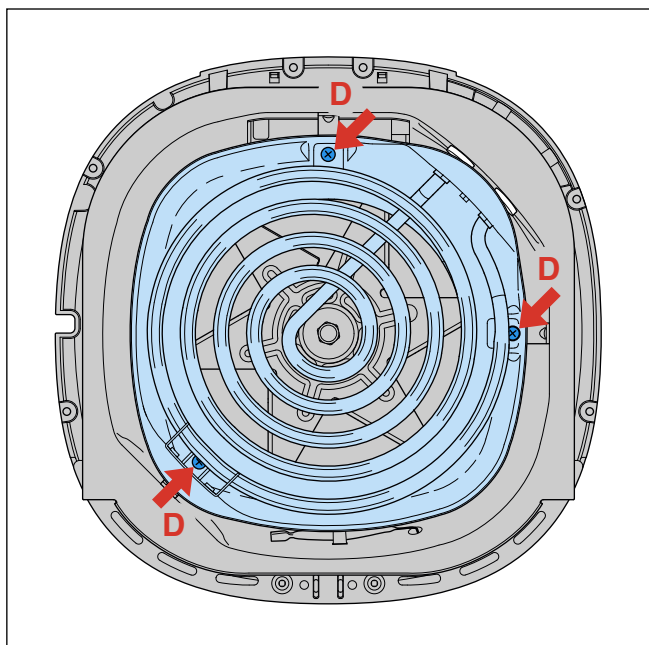

3. Cut the 2 heating element wires halfway and remove the heating element.
4. Undo the nut from the left screw thread and remove the fan.

E. Timer removal

1. Follow step A
2. Unscrew the 2 screws **F** behind the timer knob.

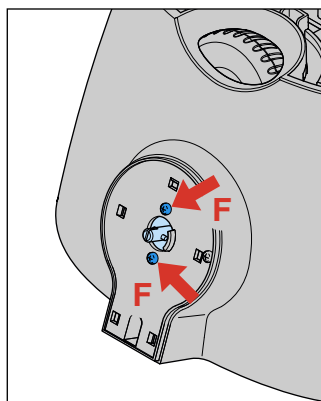

3. Remove the wires of the timer.

F. Thermostat removal

1. Follow previous step A
2. Remove the 3 screws **G** from the thermostat assy.

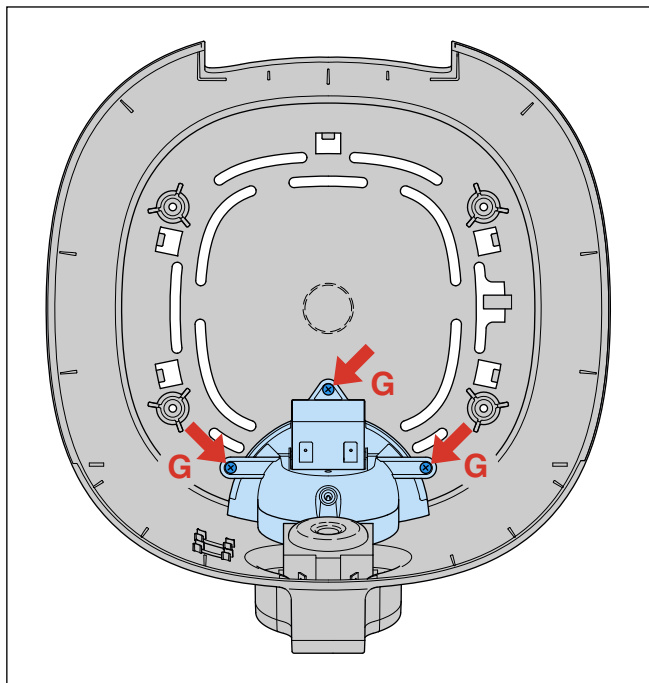

3. Follow previous step B, C, D
By step C do not cut the wires.
4. Remove the thermostat sensor by undoing the metal band.

Note: be careful with the wire/heating element connecting, this connection is fragile.

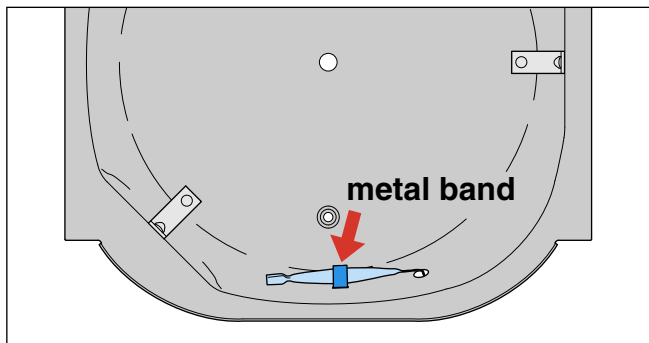

Note: Please make sure while re-assembling the new thermostat that the routing will be done as shown in below picture.

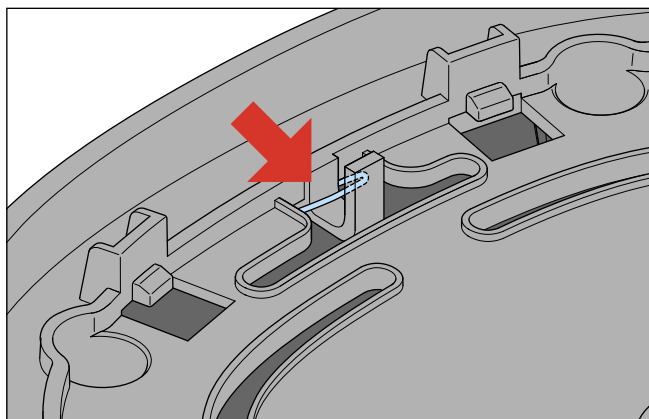

G. Motor assy removal

1. Follow previous step A, B, C, D
By step C do not cut the wires.
2. Remove the thermostat sensor (See instruction F 4)
3. Remove the fuse and the earth connection from the double heat shield.

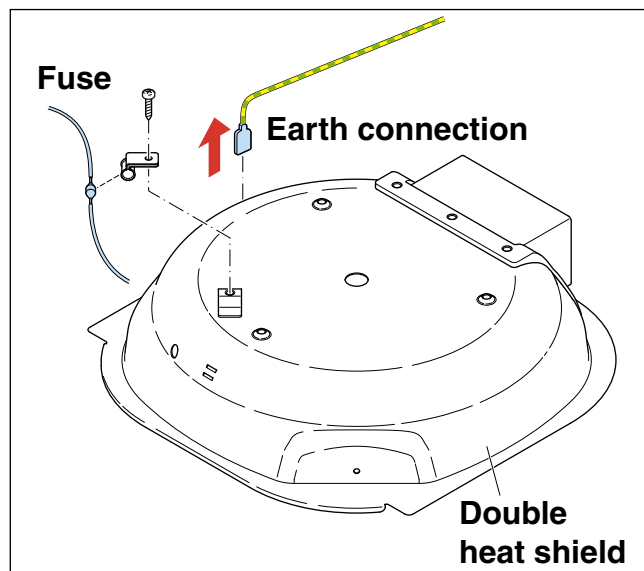

4. Cut the motor wires half way and remove the motor fan assy.

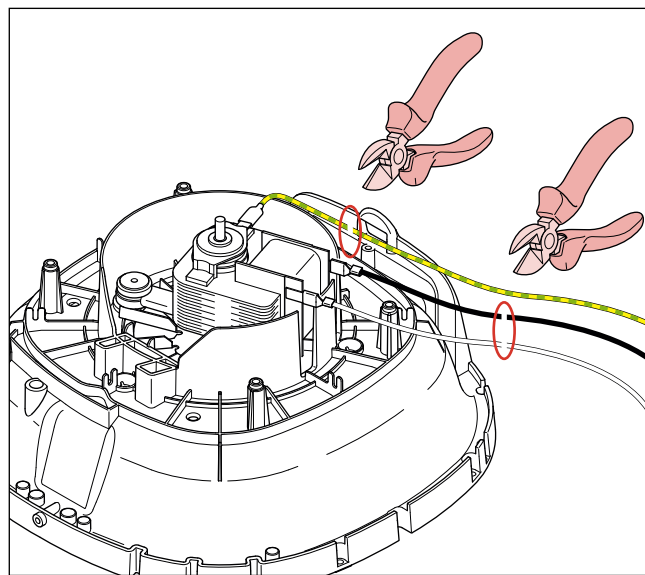

Pos	Service code	Description	
1	4222 459 49121	Cover	Black
2	4222 459 49111	Timer knob	Black
3	4222 459 49211	Timer cover	Black
4	4222 459 51901	Food separator	
5	4222 459 49081	Basket	Black
6	4222 459 49091	Basket holder (pan)	Black
7	4222 459 51911	Rubber foot	
8	4222 459 51241	Top cover	Black
9	4222 459 53251	Stainless steel timer	
10	4222 459 49181	Fuse incl. wires	
11	4222 459 49141	Fan	
	4222 459 53381	Fan	60 Hz
12	4222 459 49131	Heating element incl. wires	
	4222 459 53391	Heating element incl. wires	60 Hz
13	4222 459 49101	Base incl. wires	Black
14	4222 459 53061	Thermostat assy CCW incl. standard knop U	Black
15	4222 459 49201	Motor, fan assy	
	4222 459 53401	Motor, fan assy	60 Hz
	4222 459 51851	10 pieces of 2 wire crimp housing (CE-2)	

Electrical circuit

When the appliance does not work, check the electrical circuit.

Open the lid panel always on the underside. Always replace this panel in case of damaged, scratches body or broken click connection.

